

LEE ESTATES PLAT IV

A PLANNED UNIT DEVELOPMENT
LYING IN SECTION 35, TOWNSHIP 44 SOUTH, RANGE 42 EAST,
PALM BEACH COUNTY, FLORIDA
SHEET 2 OF 2

0605-004

134

STATE OF FLORIDA
COUNTY OF PALM BEACH
This Plat was filed for record at _____
M. this _____ day of _____ 19____
and duly recorded in Plat Book No. _____
on Page _____
Dorothy H. Wilken, Clerk of the Circuit Court
By _____ D.C.



SUBDIVISION * LEE ESTATES PLAT IV
BOOK 12 PAGE 134
FLOOD ZONE B
GRID # 33
SB 90-16
PUD NAME SCRLC
ZIP CODE 33463
TAG 9A1

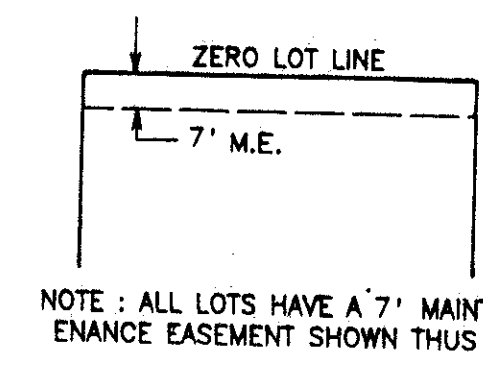

NOTE: ALL LOTS HAVE A 7' MAINTENANCE EASEMENT SHOWN THUS:

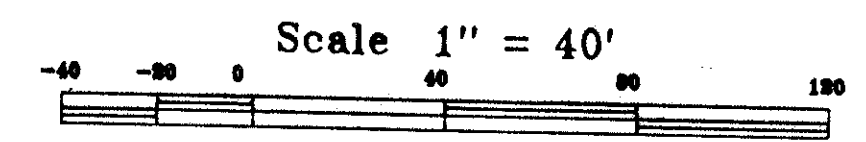

0605-004 72/134

PET. 90-16

Landmark Surveying & Mapping Inc.
1850 FOREST HILL BOULEVARD
PH. (407)433-5405 SUITE 100 W.P.B. FLORIDA

LEE ESTATES PLAT IV